

LEGEND		
EXISTING	PROPOSED	DETAILS
		BOUNDARY LINE
		STREET CENTERLINE
		EASEMENT LINE
		LOT LINES
SS	SS	SEWER PIPE
SS-1	SS-1	SS-1, ST-7, (*2)
SS-2	SS-2	SS-2, SS-2A, (*2)
SS-3	SS-3	SS-3, (*5)
SD-1	SD-1	SD-1, ST-7, (*2)
SD-2	SD-2	SD-2, (*2)
SD-4	SD-4	SD-4
SD-5	SD-5	SD-5
DW-1	DW-1	DW-1, DW-2, DW-3, ST-7, (*2)
DW-2	DW-2	DW-2, DW-3, (*2)
DW-3	DW-3	DW-3, DW-3, (*2)
DW-4	DW-4	DW-2, DW-3, (*2)
DW-5	DW-5	DW-4
DW-10A	DW-10A	DW-10A, DW-10B, DW-15
		4"x4" CATCH BASIN
		3"x3" CATCH BASIN
		INLET/OUTLET W/ GRATE
		CULINARY WATER PIPE
		45" PIPE ELBOW (W)
		22.5" PIPE ELBOW (W)
		11.25" PIPE ELBOW (W)
		FIRE HYDRANT
		3/4" SERVICE & METER (W)
		PRV(W)
		AIR-VAC VALVE (W)
		2" BLOW-OFF (W)
		VALVE (W & SW)
		TEE
		CROSS
		SECONDARY WATER PIPE
		45" PIPE ELBOW (SW)
		22.5" PIPE ELBOW (SW)
		11.25" PIPE ELBOW (SW)
		1" SINGLE SW SERVICE
		1-1/2" DUAL SW SERVICE
		SW SERVICE TO PARKS
		AIR-VAC VALVE (SW)
		BACKFLOW PREVENTER
		2" BLOW-OFF (SW)
		30" C&G (COLLECTOR)
		24" C&G (LOCAL)
		24" SHED C&G
		SIDEWALK
		STOP SIGN
		STREET SIGN
		MONUMENT
		SPRINKLER CONDUIT
		FENCE
		STREET LIGHT LOCAL
		STREET LIGHT COLLECTOR
		POWER POLE
		DITCH
		FIBER OPTIC
		GAS
		OVERHEAD POWER
		FLOW ARROW
		CONTOURS
		100 YEAR FLOOD ROUTE
		MATCH LINE
		DRIVE APPROACH
		ADA RAMP
		TRAIL

(\*1) CULINARY & SECONDARY WATER LINES LESS THAN 12" TO BE GATE VALVES. LINES 12" & LARGER REQUIRE BUTTERFLY VALVES  
(\*2) SEE PLAN & PROFILE FOR SIZE & MATERIAL  
(\*3) SEE LANDSCAPE DESIGN FOR NUMBER OF CONDUITS & SIZES  
(\*4) SEE PLAN & PROFILE FOR WIDTH & DESIGN MATERIALS  
(\*5) SEWER SERVICE MINIMUM SLOPE 2%

DATA TABLE	YARD BOX TOTAL
8" PVC PIPE	510 LF
12" PVC PIPE	1330 LF
8" TEE	9 EA
12" TEE	28 EA
8" 90° BEND	2 EA
8" GRATE	19 EA

- SHEET NOTES**
- THE BENCHMARK FOR THE TOPOGRAPHIC INFORMATION PROVIDED HEREON IS THE FOUND 1959 UTAH COUNTY MONUMENT AT THE NORTH 1/4 CORNER OF SAID SECTION 10, WITH A PUBLISHED UTAH COUNTY (NGVD29) ELEVATIONS OF 4,896.76 FEET.
  - SEE PLAN & PROFILE SHEETS FOR INFRASTRUCTURE DATA, PIPE SIZES, MATERIALS, SLOPES, JUNCTION BOXES, INLETS, CATCH BASINS, & SERVICE LATERAL LOCATIONS.
  - AREA SHOWN HEREON FALLS WITHIN FLOOD ZONE "X" (AREA DETERMINED TO BE OUTSIDE OF 500 YEAR FLOOD PLAIN) AS PER FIRM MAP NO. 49551701058 WITH AN EFFECTIVE DATE OF JULY 17, 2002.

- YARD BOX NOTES**
- ALL YARD BOX INLETS TO BE KEPT CLEAN AND ACCESSIBLE.
  - ROUTINE INSPECTION AND MAINTENANCE BY HOME OWNERS ASSOCIATION REQUIRED TO ENSURE PIPE CAPACITY.
  - OVERFLOW ROUTING TO BE PROVIDED AND MAINTAINED BETWEEN YARD BOXES AND INFILTRATION PONDS BY HOME OWNERS ASSOCIATION.



LEI

A Utah Corporation

ENGINEERS

SURVEYORS

PLANNERS

3302 N. Main Street  
Spanish Fork, UT 84660  
Phone: 801.798.0555  
Fax: 801.798.9393  
office@lei-eng.com  
www.lei-eng.com

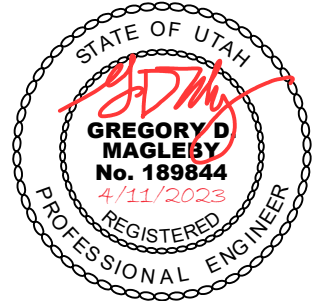

WILDFLOWER - VILLAGE 1 (NORTH) - PLATS E-5 & E-6  
CITY OF SARATOGA SPRINGS, UTAH COUNTY, UTAH  
YARD BOX GRADING PLAN

REVISIONS

1 -  
2 -  
3 -  
4 -  
5 -

LEI PROJECT #:

2013-0902

DRAWN BY:

BLS/MJV

CHECKED BY:

GDM/DAF

SCALE:

1" = 60'  
(PRINTED ON A3)

DATE:

4/11/2023

SHEET

1

U:\LAND DESKTOP\PROJECTS\13-3902 (DA COLLINS BROTHERS)\DWG\13-3902 V1 PLAT E-5 YARD BOX.DWG 3/29/2023 8:08 AM



LEGEND		
EXISTING	PROPOSED	DETAILS
		BOUNDARY LINE
		STREET CENTERLINE
		EASEMENT LINE
		LOT LINES
EX-SS	SS	SEWER PIPE
	SS	SEWER MANHOLE
EX-SD	SD	4" SEWER SERVICE
	SD	STORM DRAIN PIPE (RCP)
	SD	STORM DRAIN MANHOLE
	SD	CURB INLET
	SD	COMBO BOX
EX-W	W	4"x4" CATCH BASIN
	W	3"x3" CATCH BASIN
	W	INLET/OUTLET W/ GRATE
	W	CULINARY WATER PIPE
	W	45" PIPE ELBOW (W)
	W	22.5" PIPE ELBOW (W)
	W	11.25" PIPE ELBOW (W)
	W	FIRE HYDRANT
	W	3/4" SERVICE & METER (W)
	W	PRV(W)
	W	AIR-VAC VALVE (W)
	W	2" BLOW-OFF (W)
	W	VALVE (W & SW)
	W	TEE
	W	CROSS
EX-SW	SW	SECONDARY WATER PIPE
	SW	45" PIPE ELBOW (SW)
	SW	22.5" PIPE ELBOW (SW)
	SW	11.25" PIPE ELBOW (SW)
	SW	1" SINGLE SW SERVICE
	SW	1-1/2" DUAL SW SERVICE
	SW	SW SERVICE TO PARKS
	SW	AIR-VAC VALVE (SW)
	SW	BACKFLOW PREVENTER
	SW	2" BLOW-OFF (SW)
	SW	30" C&G (COLLECTOR)
	SW	24" C&G (LOCAL)
	SW	24" SHED C&G
	SW	SIDEWALK
	SW	STOP SIGN
	SW	STREET SIGN
	SW	MONUMENT
	SW	SPRINKLER CONDUIT
	SW	FENCE
	SW	STREET LIGHT LOCAL
	SW	STREET LIGHT COLLECTOR
	SW	POWER POLE
EX-FO	FO	DITCH
EX-GAS	GAS	FIBER OPTIC
EX-OP	OP	GAS
	OP	OVERHEAD POWER
	OP	FLOW ARROW
	OP	CONTOURS
	OP	100 YEAR FLOOD ROUTE
	OP	MATCH LINE
	OP	DRIVE APPROACH
	OP	ADA RAMP
	OP	TRAIL



(1) CULINARY & SECONDARY WATER LINES LESS THAN 12" TO BE GATE VALVES. LINES 12" & LARGER REQUIRE BUTTERFLY VALVES  
(2) SEE PLAN & PROFILE FOR SIZE & MATERIAL  
(3) SEE LANDSCAPE DESIGN FOR NUMBER OF CONDUITS & SIZES  
(4) SEE PLAN & PROFILE FOR WIDTH & DESIGN MATERIALS  
(5) SEWER SERVICE MINIMUM SLOPE 2%

#### SHEET NOTES

- THE BENCHMARK FOR THE TOPOGRAPHIC INFORMATION PROVIDED HEREON IS THE FOUND 1959 UTAH COUNTY MONUMENT AT THE NORTH 1/4 CORNER OF SAID SECTION 10, WITH A PUBLISHED UTAH COUNTY (NGVD29) ELEVATIONS OF 4,896.76 FEET.
- CATCH SLOPE NOT TO EXCEED 3:1 SLOPE MAX.
- LOT GRADING NOT TO EXCEED 3:1 SLOPE, TERRACING & RETAINING WALLS MAY BE USED TO IMPROVE BUILDING PAD SITE IN ACCORDANCE WITH CITY STANDARDS. (TO BE DETERMINED ON FINAL LOT DRAWINGS).
- SEE PLAN & PROFILE SHEETS FOR INFRASTRUCTURE DATA, PIPE SIZES, MATERIALS, SLOPES, JUNCTION BOXES, INLETS, CATCH BASINS, & SERVICE LATERAL LOCATIONS.
- AREA SHOWN HEREON FALLS WITHIN FLOOD ZONE "X" (AREA DETERMINED TO BE OUTSIDE OF 500 YEAR FLOOD PLAIN) AS PER FIRM MAP NO. 4955170105B WITH AN EFFECTIVE DATE OF JULY 17, 2002.

#### YARD BOX NOTES

- ALL YARD BOX INLETS TO BE KEPT CLEAN AND ACCESSIBLE.
- ROUTINE INSPECTION AND MAINTENANCE BY HOME OWNERS ASSOCIATION REQUIRED TO ENSURE PIPE CAPACITY.
- OVERFLOW ROUTING TO BE PROVIDED AND MAINTAINED BETWEEN YARD BOXES AND INFILTRATION PONDS BY HOME OWNERS ASSOCIATION.

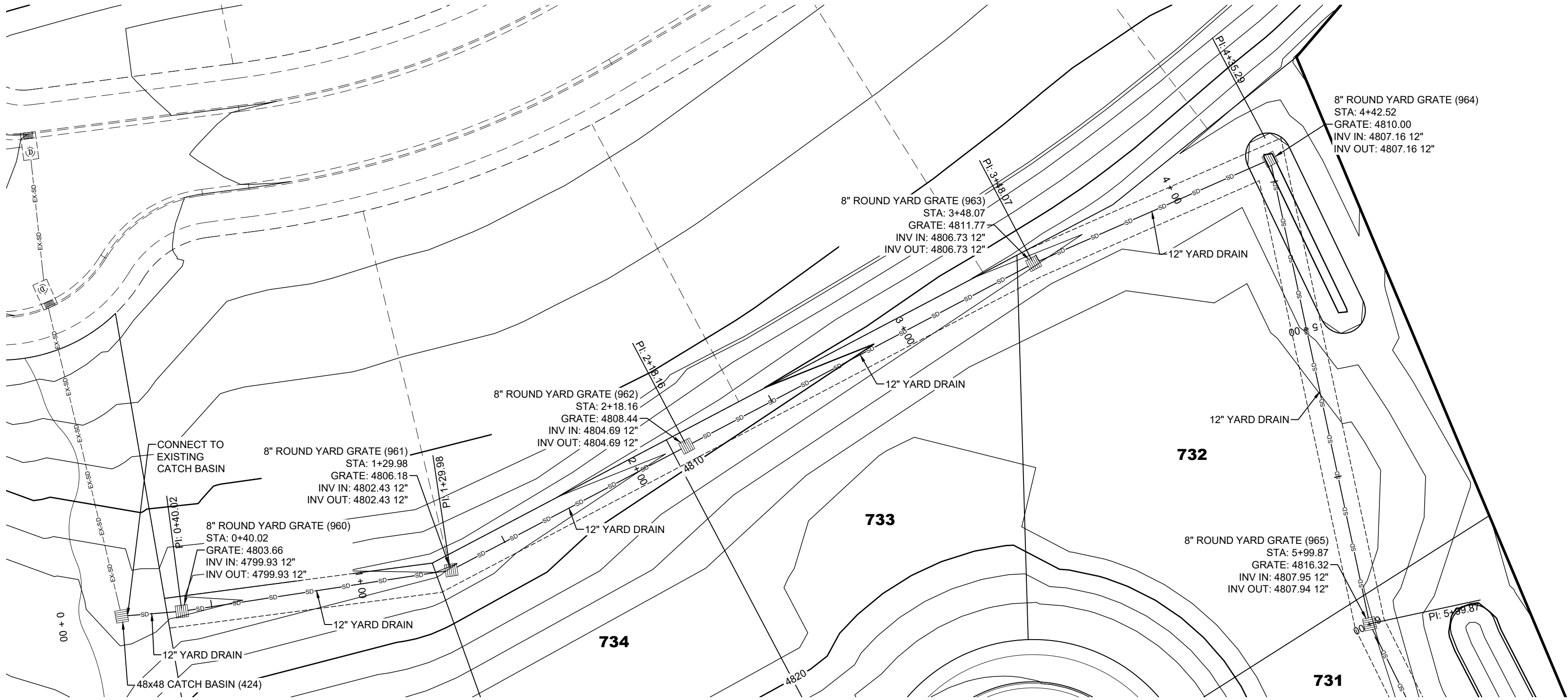

YARD BOX PLAN VIEW

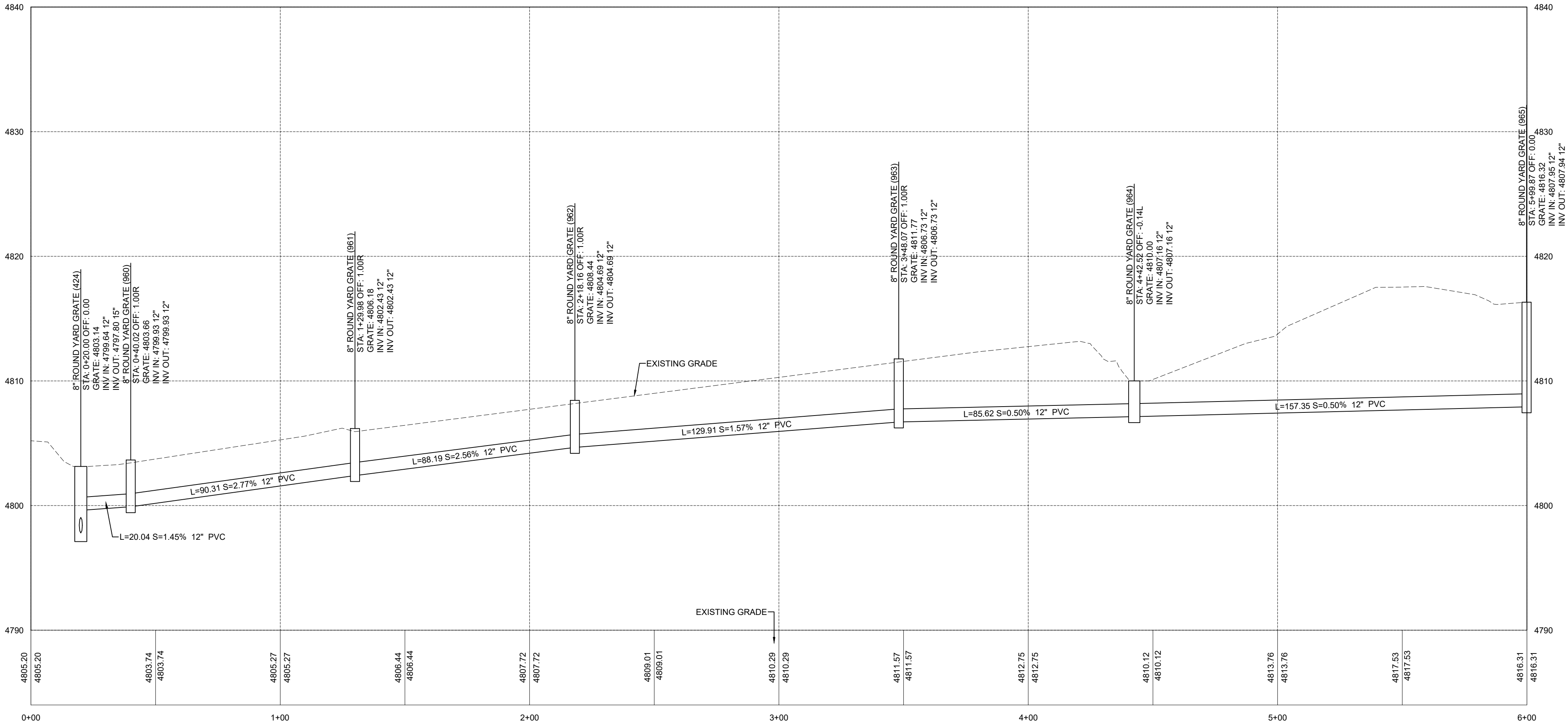

YARD BOX PROFILE

**LEI**  
- A Utah Corporation -  
**ENGINEERS**  
**SURVEYORS**  
**PLANNERS**  
3302 N. Main Street  
Spanish Fork, UT 84660  
Phone: 801.798.0555  
Fax: 801.798.9393  
office@lei-eng.com  
www.lei-eng.com

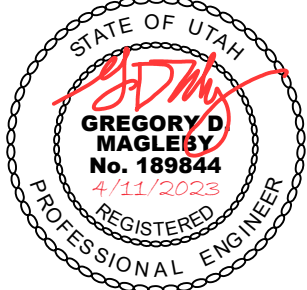

**WILDFLOWER - VILLAGE 1 (NORTH) - PLATS E-5 & E-6**  
CITY OF SARATOGA SPRINGS, UTAH COUNTY, UTAH  
**YARD BOX PLAN & PROFILE**  
**STA: 6+00 TO 12+00**

#### REVISIONS

1	-
2	-
3	-
4	-
5	-

LEI PROJECT #:

2013-0902

DRAWN BY:

BLS/MJV

CHECKED BY:

GDM/DAF

SCALE:

1" = 30'

(PORTION OF PLATS)

DATE

4/11/2023

SHEET

2



EXISTING	PROPOSED	DETAILS
		BOUNDARY LINE
		STREET CENTERLINE
		EASEMENT LINE
		LOT LINES
EX-SS	SS	SEWER PIPE
	SS	SEWER MANHOLE
EX-SD	SD	4" SEWER SERVICE
	SD	STORM DRAIN PIPE (RCP)
	SD	STORM DRAIN MANHOLE
	SD	CURB INLET
	SD	COMBO BOX
EX-W	W	4"x4" CATCH BASIN
	W	3"x3" CATCH BASIN
	W	INLET/OUTLET W/ GRATE
	W	CULINARY WATER PIPE
	W	45" PIPE ELBOW (W)
	W	22.5" PIPE ELBOW (W)
	W	11.25" PIPE ELBOW (W)
	W	FIRE HYDRANT
	W	3/4" SERVICE & METER (W)
	W	PRV(W)
		AIR-VAC VALVE (W)
		2" BLOW-OFF (W)
		VALVE (W & SW)
		TEE
		CROSS
EX-SW	SW	SECONDARY WATER PIPE
	SW	45" PIPE ELBOW (SW)
	SW	22.5" PIPE ELBOW (SW)
	SW	11.25" PIPE ELBOW (SW)
	SW	1" SINGLE SW SERVICE
	SW	1-1/2" DUAL SW SERVICE
	SW	SW SERVICE TO PARKS
	SW	AIR-VAC VALVE (SW)
	SW	BACKFLOW PREVENTER
	SW	2" BLOW-OFF (SW)
	SW	30" C&G (COLLECTOR)
	SW	24" C&G (LOCAL)
	SW	24" SHED C&G
	SW	SIDEWALK
		STOP SIGN
		STREET SIGN
		MONUMENT
		SPRINKLER CONDUIT
		FENCE
		STREET LIGHT LOCAL
		STREET LIGHT COLLECTOR
		POWER POLE
		DITCH
EX-FO	FO	FIBER OPTIC
EX-GAS	GAS	GAS
EX-OW	OW	OVERHEAD POWER
		FLOW ARROW
		CONTOURS
		100 YEAR FLOOD ROUTE
		MATCH LINE
		DRIVE APPROACH
		ADA RAMP
		TRAIL





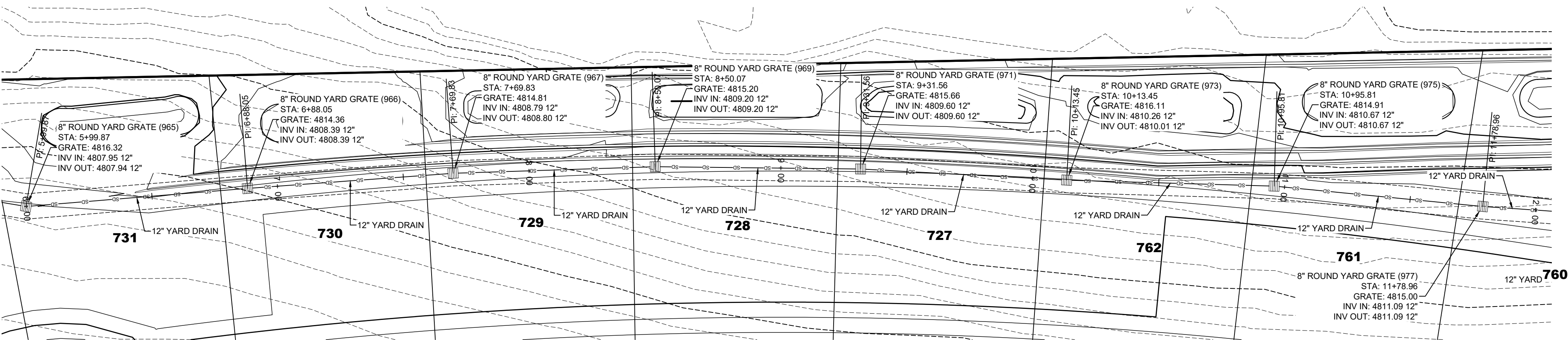

YARD BOX PLAN VIEW  
CENTER LINE OMITTED FOR CLARITY

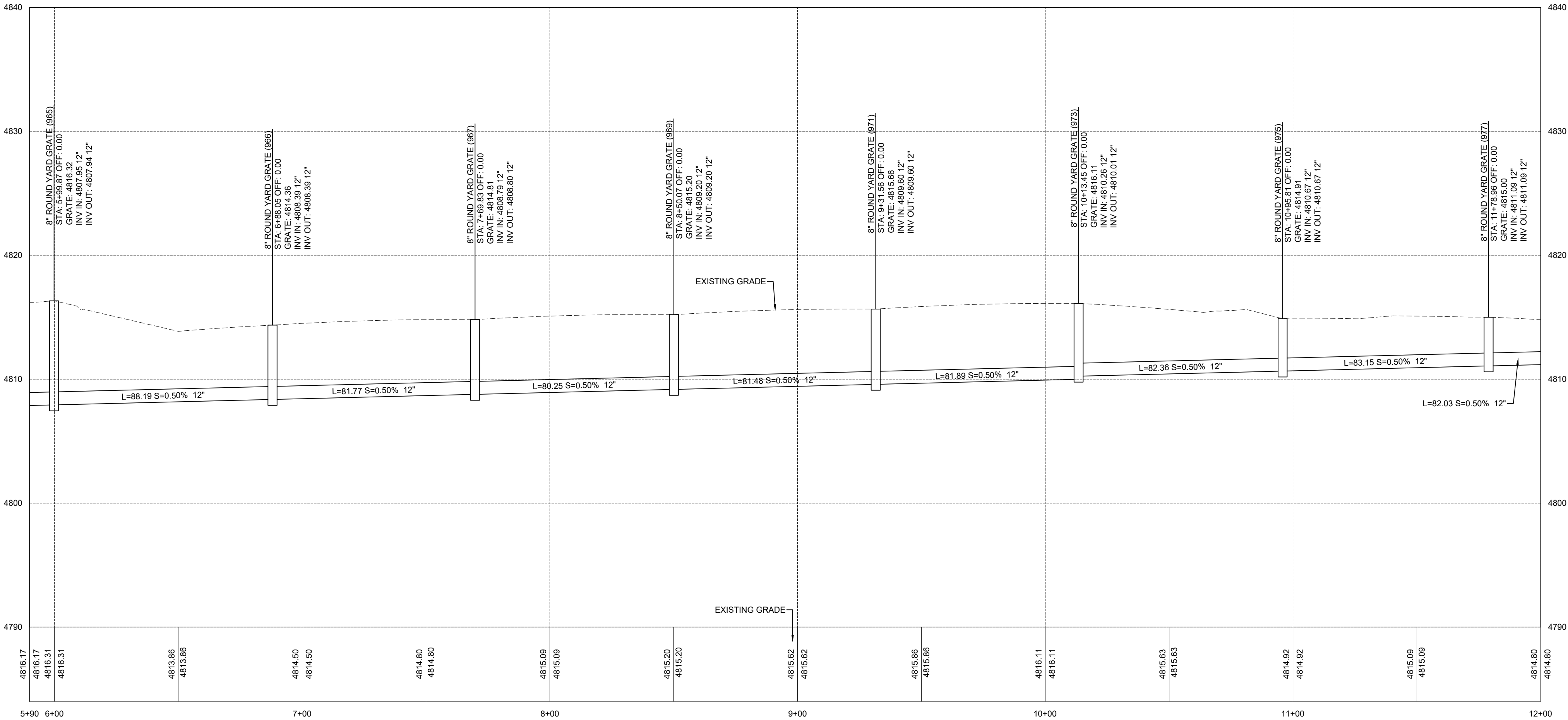

YARD BOX PROFILE

SHEET NOTES

- THE BENCHMARK FOR THE TOPOGRAPHIC INFORMATION PROVIDED HEREON IS THE FOUND 1959 UTAH COUNTY MONUMENT AT THE NORTH 1/4 CORNER OF SAID SECTION 10, WITH A PUBLISHED UTAH COUNTY (NGVD29) ELEVATIONS OF 4,896.76 FEET.
- CATCH SLOPE NOT TO EXCEED 3:1 SLOPE MAX.
- LOT GRADING NOT TO EXCEED 3:1 SLOPE, TERRACING & RETAINING WALLS MAY BE USED TO IMPROVE BUILDING PAD SITE IN ACCORDANCE WITH CITY STANDARDS. (TO BE DETERMINED ON FINAL LOT DRAWINGS).
- SEE PLAN & PROFILE SHEETS FOR INFRASTRUCTURE DATA, PIPE SIZES, MATERIALS, SLOPES, JUNCTION BOXES, INLETS, CATCH BASINS, & SERVICE LATERAL LOCATIONS.
- AREA SHOWN HEREON FALLS WITHIN FLOOD ZONE "X" (AREA DETERMINED TO BE OUTSIDE OF 500 YEAR FLOOD PLAIN) AS PER FIRM MAP NO. 4955170105B WITH AN EFFECTIVE DATE OF JULY 17, 2002.

YARD BOX NOTES

- ALL YARD BOX INLETS TO BE KEPT CLEAN AND ACCESSIBLE.
- ROUTINE INSPECTION AND MAINTENANCE BY HOME OWNERS ASSOCIATION REQUIRED TO ENSURE PIPE CAPACITY.
- OVERFLOW ROUTING TO BE PROVIDED AND MAINTAINED BETWEEN YARD BOXES AND INFILTRATION PONDS BY HOME OWNERS ASSOCIATION.



- A Utah Corporation -

ENGINEERS

SURVEYORS

PLANNERS

3302 N. Main Street  
Spanish Fork, UT 84660  
Phone: 801.798.0555  
Fax: 801.798.9393  
office@lei-eng.com  
www.lei-eng.com

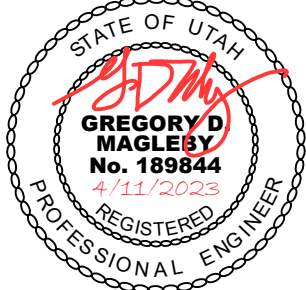

WILDFLOWER - VILLAGE 1 (NORTH) - PLATS E-5 & E-6

CITY OF SARATOGA SPRINGS, UTAH COUNTY, UTAH

YARD BOX PLAN & PROFILE

STA: 6+00 TO 12+00

REVISIONS

1	-
2	-
3	-
4	-
5	-

LEI PROJECT #:

2013-0902

DRAWN BY:

BLS/MJV

CHECKED BY:

GDM/DAF

SCALE:

1" = 30'

(PRINTED ON A436)

DATE:

4/11/2023

SHEET



EXISTING	PROPOSED	DETAILS
		BOUNDARY LINE
		STREET CENTERLINE
		EASEMENT LINE
		LOT LINES
EX-SS	SS	SEWER PIPE
	SS	SEWER MANHOLE
EX-SD	SD	4" SEWER SERVICE
	SD	STORM DRAIN PIPE (RCP)
	SD	STORM DRAIN MANHOLE
	SD	CURB INLET
	SD	COMBO BOX
EX-W	W	4"x4" CATCH BASIN
	W	3"x3" CATCH BASIN
	W	INLET/OUTLET W/ GRATE
	W	CULINARY WATER PIPE
	W	45" PIPE ELBOW (W)
	W	22.5" PIPE ELBOW (W)
	W	11.25" PIPE ELBOW (W)
	W	FIRE HYDRANT
	W	3/4" SERVICE & METER (W)
	W	PRV(W)
		AIR-VAC VALVE (W)
		2" BLOW-OFF (W)
		VALVE (W & SW)
		TEE
		CROSS
EX-SW	SW	SECONDARY WATER PIPE
	SW	45" PIPE ELBOW (SW)
	SW	22.5" PIPE ELBOW (SW)
	SW	11.25" PIPE ELBOW (SW)
	SW	1" SINGLE SW SERVICE
	SW	1-1/2" DUAL SW SERVICE
	SW	SW SERVICE TO PARKS
	SW	AIR-VAC VALVE (SW)
	SW	BACKFLOW PREVENTER
	SW	2" BLOW-OFF (SW)
	SW	30" C&G COLLECTOR
	SW	24" C&G (LOCAL)
	SW	24" SHED C&G
	SW	SIDEWALK
		STOP SIGN
		STREET SIGN
		MONUMENT
		SPRINKLER CONDUIT
		FENCE
		STREET LIGHT LOCAL
		STREET LIGHT COLLECTOR
		POWER POLE
		DITCH
EX-FO	FO	FIBER OPTIC
EX-GAS	GAS	GAS
EX-OW	OW	OVERHEAD POWER
		FLOW ARROW
		CONTOURS
		100 YEAR FLOOD ROUTE
		MATCH LINE
		DRIVE APPROACH
		ADA RAMP
		TRAIL



(\*)CULINARY & SECONDARY WATER LINES LESS THAN 12" TO BE GATE VALVES. LINES 12" & LARGER REQUIRE BUTTERFLY VALVES.  
(2)SEE PLAN & PROFILE FOR SIZE & MATERIAL  
(3)SEE LANDSCAPE DESIGN FOR NUMBER OF CONDUITS & SIZES  
(4)SEE PLAN & PROFILE FOR WIDTH & DESIGN MATERIALS  
(5) SEWER SERVICE MINIMUM SLOPE 2%

#### SHEET NOTES

- THE BENCHMARK FOR THE TOPOGRAPHIC INFORMATION PROVIDED HEREON IS THE FOUND 1959 UTAH COUNTY MONUMENT AT THE NORTH 1/4 CORNER OF SAID SECTION 10, WITH A PUBLISHED UTAH COUNTY (NGVD29) ELEVATIONS OF 4,896.76 FEET.
- CATCH SLOPE NOT TO EXCEED 3:1 SLOPE MAX.
- LOT GRADING NOT TO EXCEED 3:1 SLOPE. TERRACING & RETAINING WALLS MAY BE USED TO IMPROVE BUILDING PAD SITE IN ACCORDANCE WITH CITY STANDARDS. (TO BE DETERMINED ON FINAL LOT DRAWINGS).
- SEE PLAN & PROFILE SHEETS FOR INFRASTRUCTURE DATA, PIPE SIZES, MATERIALS, SLOPES, JUNCTION BOXES, INLETS, CATCH BASINS, & SERVICE LATERAL LOCATIONS. AREA SHOWN HEREON FALLS WITHIN FLOOD ZONE "X" (AREA DETERMINED TO BE OUTSIDE OF 500 YEAR FLOOD PLAIN) AS PER FIRM MAP NO. 49551701058 WITH AN EFFECTIVE DATE OF JULY 17, 2002.

#### YARD BOX NOTES

- ALL YARD BOX INLETS TO BE KEPT CLEAN AND ACCESSIBLE.
- ROUTINE INSPECTION AND MAINTENANCE BY HOME OWNERS ASSOCIATION REQUIRED TO ENSURE PIPE CAPACITY.
- OVERFLOW ROUTING TO BE PROVIDED AND MAINTAINED BETWEEN YARD BOXES AND INFILTRATION PONDS BY HOME OWNERS ASSOCIATION.

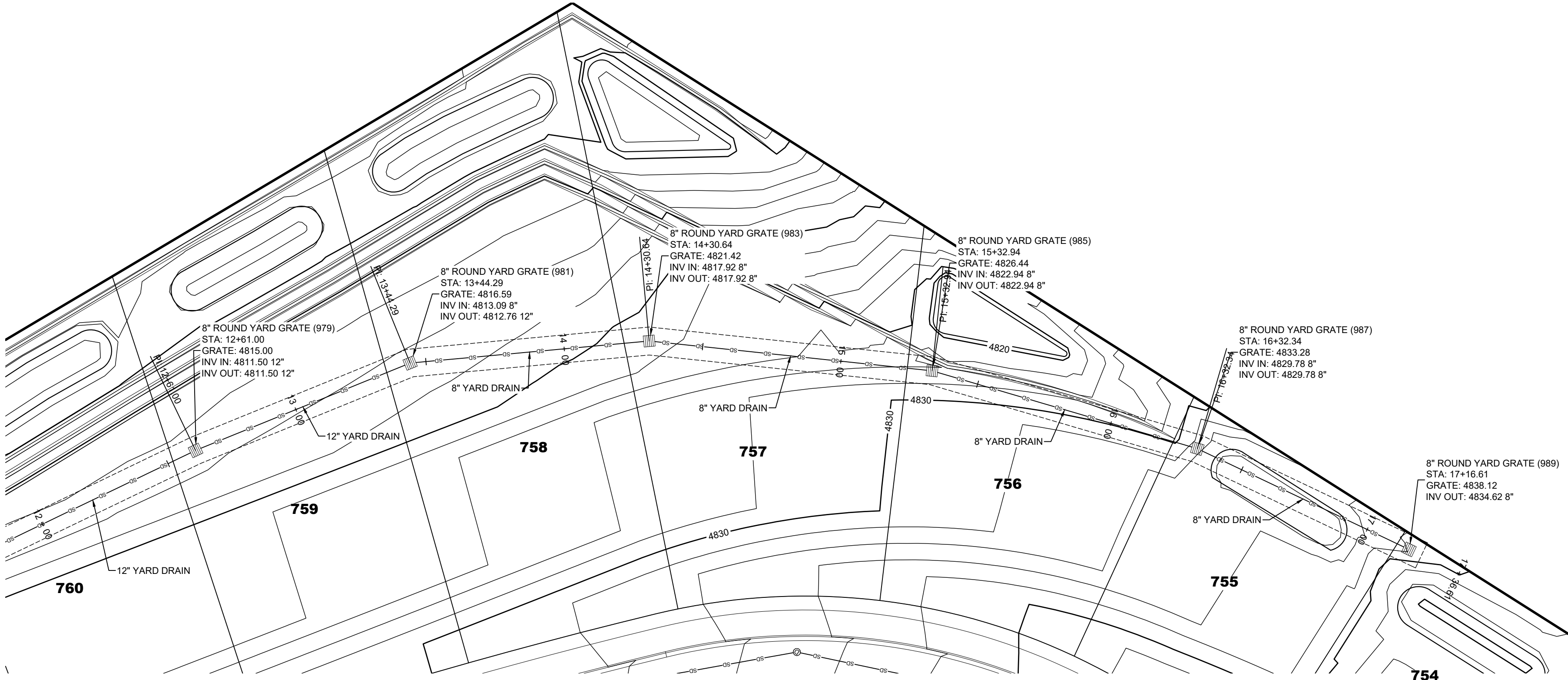

YARD BOX PLAN VIEW

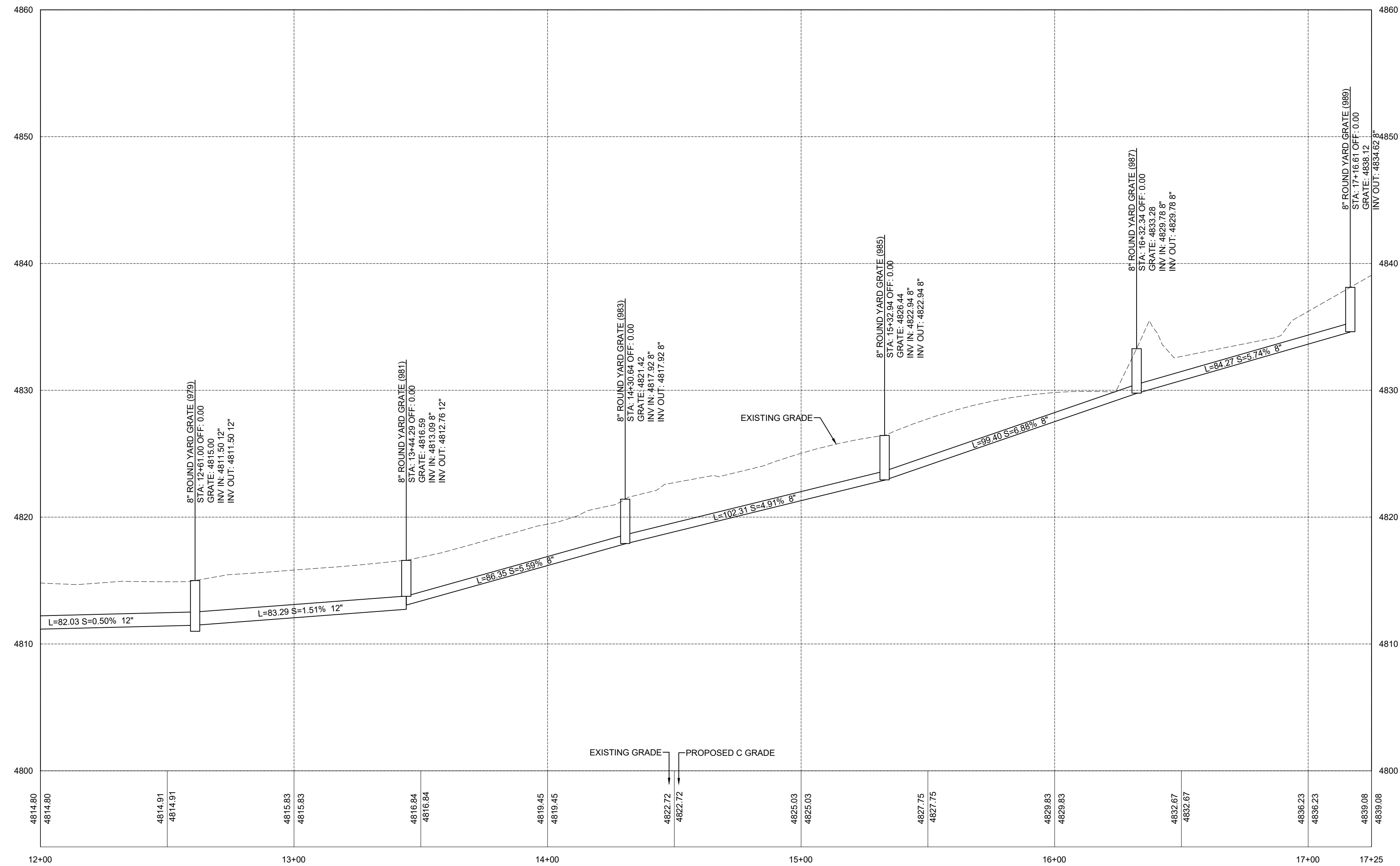

YARD BOX PROFILE

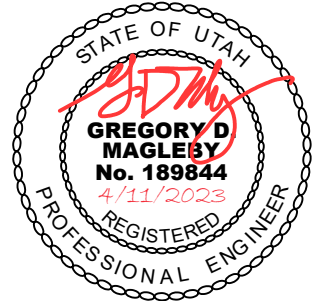

## WILDFLOWER - VILLAGE 1 (NORTH) - PLATS E-5 & E-6

CITY OF SARATOGA SPRINGS, UTAH COUNTY, UTAH

### YARD BOX PLAN & PROFILE

STA: 6+00 TO 12+00

#### REVISIONS

1	-
2	-
3	-
4	-
5	-

LEI PROJECT #:

2013-0902

DRAWN BY:

BLS/MJV

CHECKED BY:

GDM/DAF

SCALE:

1" = 30'

(PRINTED ON A3)

DATE

4/11/2023

SHEET

4



U:\LAND DESKTOP PROJECTS\15-0902 SARATOGA SPRINGS\BROUWER\WORKSHEETS\15-0902\_OPEN SPACE\_EXHIBIT.DWG 7/31/2020 10:10 AM

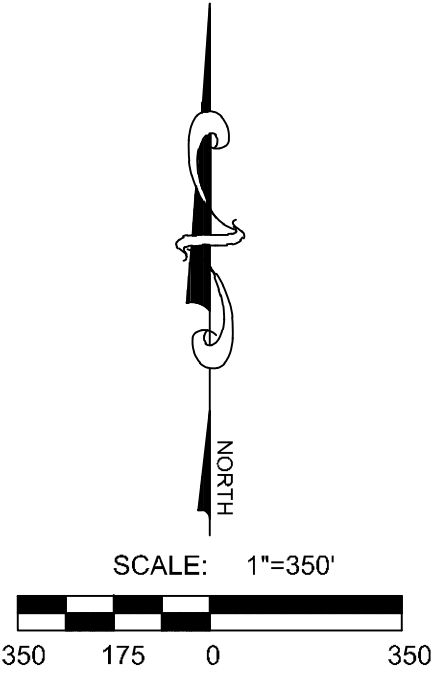
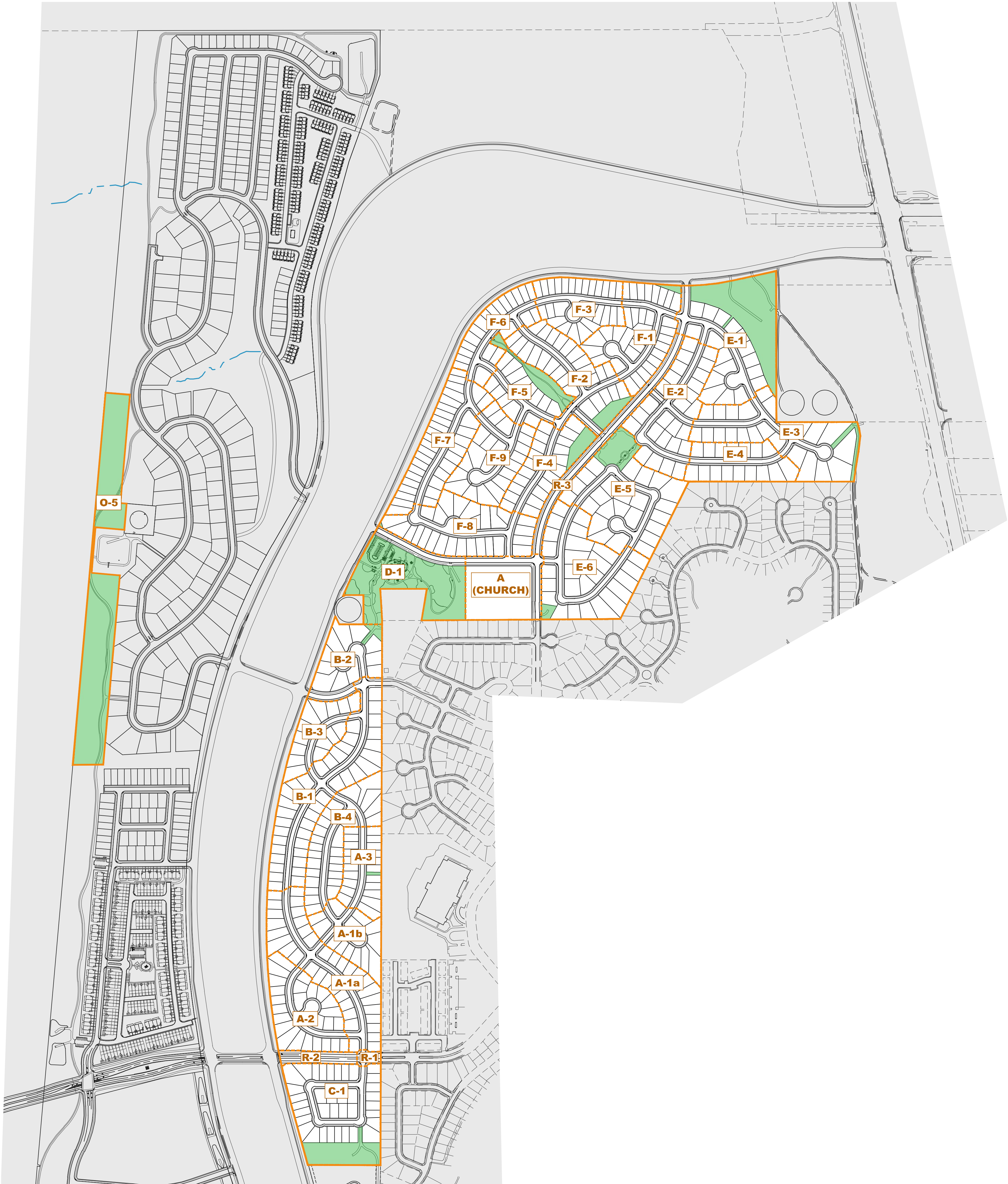

LEI

- A Utah Corporation -

ENGINEERS

SURVEYORS

PLANNERS

3302 N. Main Street  
Spanish Fork, UT 84660  
Phone: 801.798.0555  
Fax: 801.798.9393  
office@lei-eng.com  
www.lei-eng.com

WILDFLOWER

CITY OF SARATOGA SPRINGS, UTAH COUNTY, UTAH

VILLAGE 1 - OPEN SPACE EXHIBIT

REVISIONS	
1	
2	
3	
4	
5	
6	

LEI PROJECT #:  
2013-0902

DRAWN BY:  
BLS

DESIGNED BY:  
GDM

SCALE:  
1"=350'

DATE:  
7/31/2020



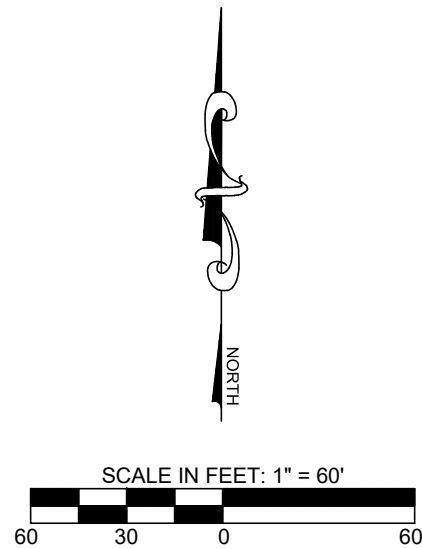

LEI

- A Utah Corporation -

ENGINEERS

SURVEYORS

PLANNERS

3302 N. Main Street  
Spanish Fork, UT 84660  
Phone: 801.798.0555  
Fax: 801.798.9393  
office@lei-eng.com  
www.lei-eng.com

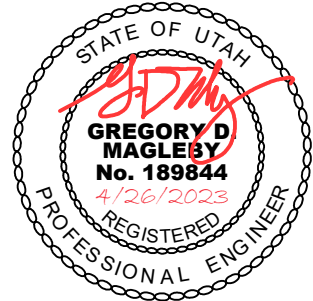

WILDFLOWER - VILLAGE 1 (NORTH) - PLATS E-5 & E-6

CITY OF SARATOGA SPRINGS, UTAH COUNTY, UTAH

YARD BOX EASEMENT EXHIBIT

REVISIONS	
1	
2	
3	
4	
5	

LEI PROJECT #:  
2013-0902

DRAWN BY:  
BLS/MJV

CHECKED BY:  
GDM/DAF

SCALE:  
1" = 60'  
(PRINTED ON A436)

DATE:  
4/26/2023



