

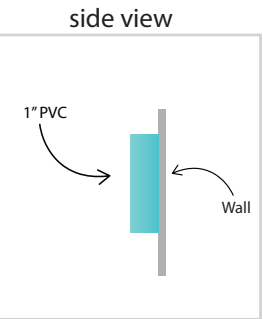

New Sign Specifications

Building Face: 1024" w x 429" h - 3050 sq ft
Sign Dimensions: 130" w x 30" h - 27 sq ft
Percentage of building fascia: ~0.008%
Materials: 1" Painted PVC & Black Vinyl
Depth: 1"
Non Lit Sign
Dimensional Signage
Signage attached flush to building face - Stud Mounted
Sign adhered to building face using appropriate hardware/fasteners

****Will be removing existing signage and reinstalling at this location**
We CANNOT guarantee that there won't be any damage to sign upon removal
Client is responsible for any damage to sign that needs to be redone

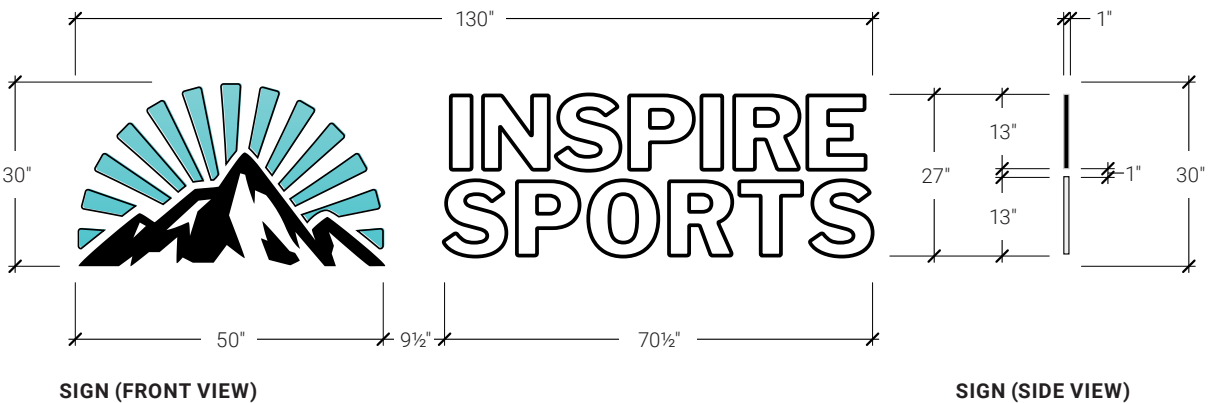

Project:

1509 North Commerce Dr
Saratoga Springs, UT 84045
Zone:

City Code

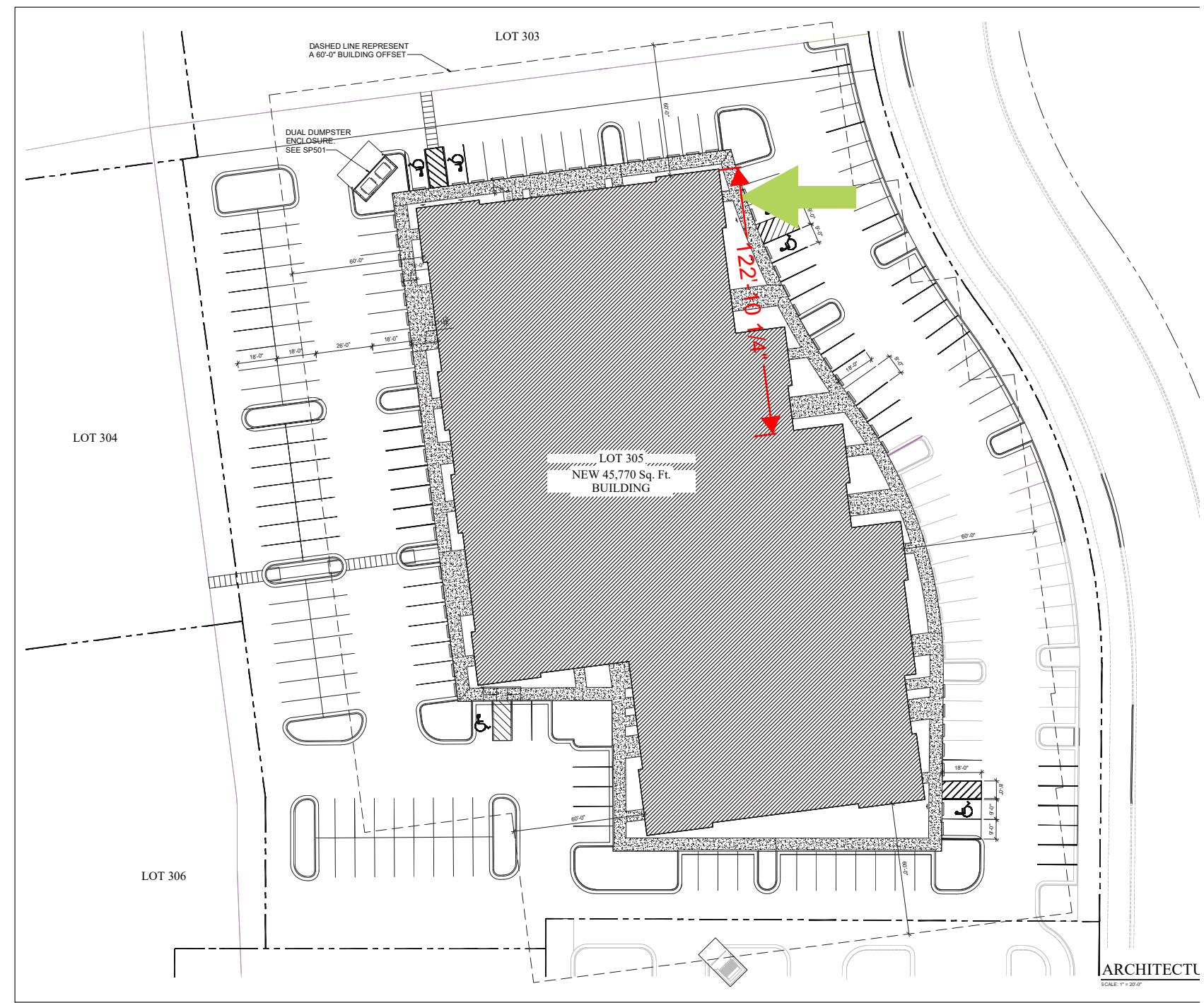

Proposed Signage

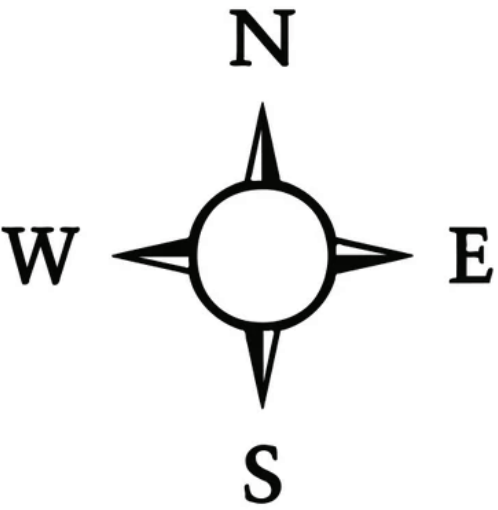

COLOR/MATERIAL SPECIFICATIONS:

ALUMINUM CHANNEL LETTERS

