

REVISIONS
R1: ADDED THE CORRECT LED LAYOUT TO SIGN PACKAGE - 8/27/25 CT
R2: ADDED BUILDING SF AND SIGN AREA SF PER CITIES REQUEST
UPDATED THE LED COLORS PER THE CITIES REQUEST
ADDED SITE PLAN - 12/5/25 CT
R3: ADDED ILLUMINATION TIME AND CANDLE MEASUREMENTS PER THE
CITIES REQUEST - 12/8/25 CT
R4: UPDATE LED LAYOUT PER CITIES REQUEST
UPDATE FOOT CANDLE MEASUREMENT PER CITIES REQUEST - 12/15/25 CT

Exhibit 1



Since 1930

111 SOUTH HUNTINGTON STREET, POMONA, CA 91766

STATE LICENSE #211502

909-622-5304 FAX 909-620-4726



Member of



California Sign Association

PROJECT:

IN-N-OUT
UTAH WAREHOUSE

ADDRESS:

2238 N. REDWOOD RD.
SARATOGA SPRINGS, UT

DATE: 8/22/25

SCALE:

DRAWN BY: CRYSTAL TERBERG

DESIGN: INO-UT-WAREHOUSE-SS-R4

REVISION: 12/15/25

CUSTOMER APPROVAL:

This drawing is for customer review and approval before fabrication.
Williams Sign Co. will not be responsible for any errors or discrepancies
that could have been prevented by review of this document.

• This customer shall provide accessibility to remove transformers and/or

A dedicated 120 volt sign circuits with a ground wire to be provided within
6 ft. of the sign(s) by customer.

• Drawing may vary in color to actual material or paint color due to printing
limitations. Photos showing sign placement are for a visual reference only.
Size and placement may vary

Signature _____ Title _____ Date _____



All electrical signs shall comply with the National
Electric Code (Article 600) and manufactured
according to Underwriters Laboratories U.L. 48
standards and labeled accordingly.

COPYRIGHT 2025

This drawing and all images are the sole
property of Williams Sign Co. and may not
be reproduced or transmitted, in full or in
part, to anyone without the written
permission from Williams Sign Co.

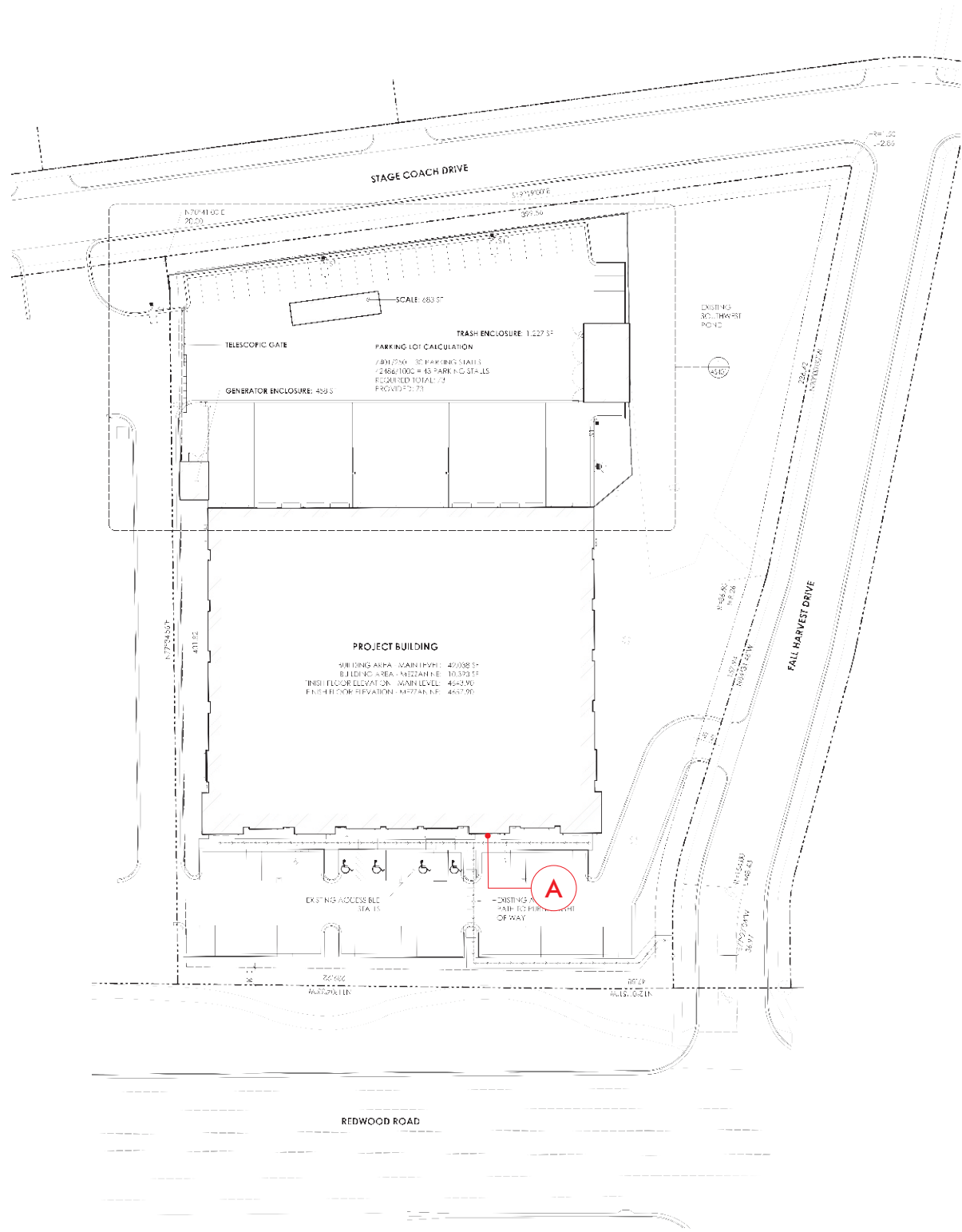

SIGN LEGEND

SIGN #	DESCRIPTION	SF	QTY
A	ILLUMINATED WALL SIGN	180.3	1

PAGE NO.

2



Since 1930

111 SOUTH HUNTINGTON STREET, POMONA, CA 91766

STATE LICENSE #211502

909-622-5304 FAX 909-620-4726



PROJECT:

IN-N-OUT
UTAH WAREHOUSE

ADDRESS:

2238 N. REDWOOD RD.
SARATOGA SPRINGS, UT

DATE: 8/22/25

SCALE:

DRAWN BY: CRYSTAL TERBERG

DESIGN: INO-UT-WAREHOUSE-SS-R4

REVISION: 12/15/25

CUSTOMER APPROVAL:

This drawing is for customer review and approval before fabrication. Williams Sign Co. will not be responsible for any errors or discrepancies that could have been prevented by review of this document.

• This customer shall provide accessibility to remove transformers and/or

A dedicated 120 volt sign circuits with a ground wire to be provided within 6 ft. of the sign(s) by customer.

• Drawing may vary in color to actual material or paint color due to printing limitations. Photos showing sign placement are for a visual reference only. Size and placement may vary

Signature _____ Title _____ Date _____



All electrical signs shall comply with the National Electric Code (Article 600) and manufactured according to Underwriters Laboratories U.L. 48 standards and labeled accordingly.

COPYRIGHT 2025

This drawing and all images are the sole property of Williams Sign Co. and may not be reproduced or transmitted, in full or in part, to anyone without the written permission from Williams Sign Co.

FRONT ELEVATION



PAGE NO.

4



Since 1930

111 SOUTH HUNTINGTON STREET, POMONA, CA 91766

STATE LICENSE #211502

909-622-5304 FAX 909-620-4726



Member of



California Sign Association

PROJECT:

IN-N-OUT
UTAH WAREHOUSE

ADDRESS:

2238 N. REDWOOD RD.
SARATOGA SPRINGS, UT

DATE: 8/22/25

SCALE:

DRAWN BY: CRYSTAL TERBERG

DESIGN: INO-UT-WAREHOUSE-SS-R4

REVISION: 12/15/25

CUSTOMER APPROVAL:

This drawing is for customer review and approval before fabrication. Williams Sign Co. will not be responsible for any errors or discrepancies that could have been prevented by review of this document.

• This customer shall provide accessibility to remove transformers and/or

A dedicated 120 volt sign circuits with a ground wire to be provided within 6 ft. of the sign(s) by customer.

• Drawing may vary in color to actual material or paint color due to printing limitations. Photos showing sign placement are for a visual reference only. Size and placement may vary

Signature

Title

Date



All electrical signs shall comply with the National Electric Code (Article 600) and manufactured according to Underwriters Laboratories U.L. 48 standards and labeled accordingly.

COPYRIGHT 2025

This drawing and all images are the sole property of Williams Sign Co. and may not be reproduced or transmitted, in full or in part, to anyone without the written permission from Williams Sign Co.